

## CHANGING THE NEEDLE

- ① Turn the balance wheel towards you until the needle is at its highest position.
- ② Loosen the needle clamp screw by turning its top edge towards you. Remove the needle from the clamp.
- ③ Place the new needle into the needle clamp with its flat side facing away from you. Push the needle up into needle clamp as far as possible.
- ④ Tighten the needle clamp screw firmly.

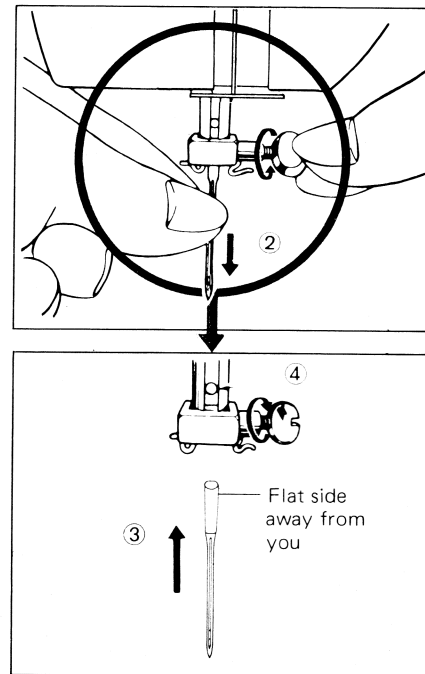

## TO SELECT A SUITABLE NEEDLE

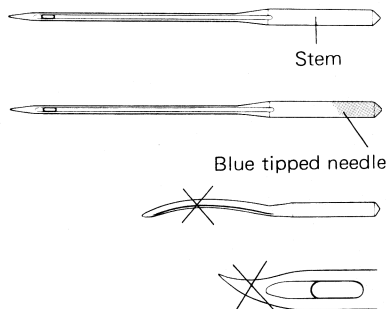

■ A number indicating the size of needle is marked on the stem. The higher the number, the thicker the needle.

■ A **BLUE TIPPED** needle is supplied with the machine.

\*Do not use any needle which is bent or blunted.